

by RollingCenter  
Never stop



# CARRELLI AUTOPORTANTI

Cantilever gate carriages  
Rollenapparate für freitragende Schiebetore  
Chariots pour portail autoportants  
Carros para cancelas autoportantes  
Тележки для раздвижных ворот





**A**



- 41 B
- 41 B/SPEC
- 41 P
- 41 P/SPEC
- 41 H
- 41 H/SPEC
- 41 G
- 41 G/SPEC
- 41 G-A
- 41 SM

**B**



- 2 RP
- 4 RP
- 4 RM
- 4 RG
- 2 RG
- 4 RM R
- 4 RG R

**C**



- G-A
- GIPI 4 RP / Z
- GIPI 5 RG / Z
- GIPI 4 RH / Z
- GIPI 6 RM / Z
- GIPI 4 RM2
- GIPI 4 RMC2
- GIPI 4 RSM

**D**



- 153/B
- 153/P
- 153/G
- 153/H

**E**



- PF/B
- PF/P
- PF/G



F



- 50 B
- 50 BL
- 50 P
- 50 PL
- 50 H
- 50 G
- 50 GL
- 50 SM
- 50 R
- 50 RL

G

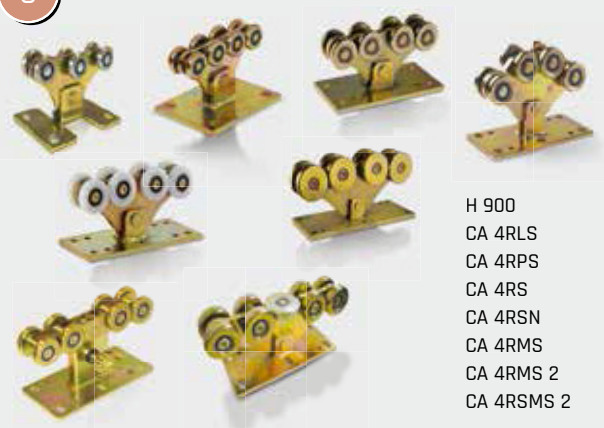

- H 900
- CA 4RLS
- CA 4RPS
- CA 4RS
- CA 4RSN
- CA 4RMS
- CA 4RMS 2
- CA 4RSMS 2

H



**DIMA**

DIMA permette il perfetto allineamento tra i 2 carrelli, eliminando ogni errore di montaggio.

DIMA enables the perfect alignment of the 2 carriages, thus eliminating any installation error

I



**GLOECK**

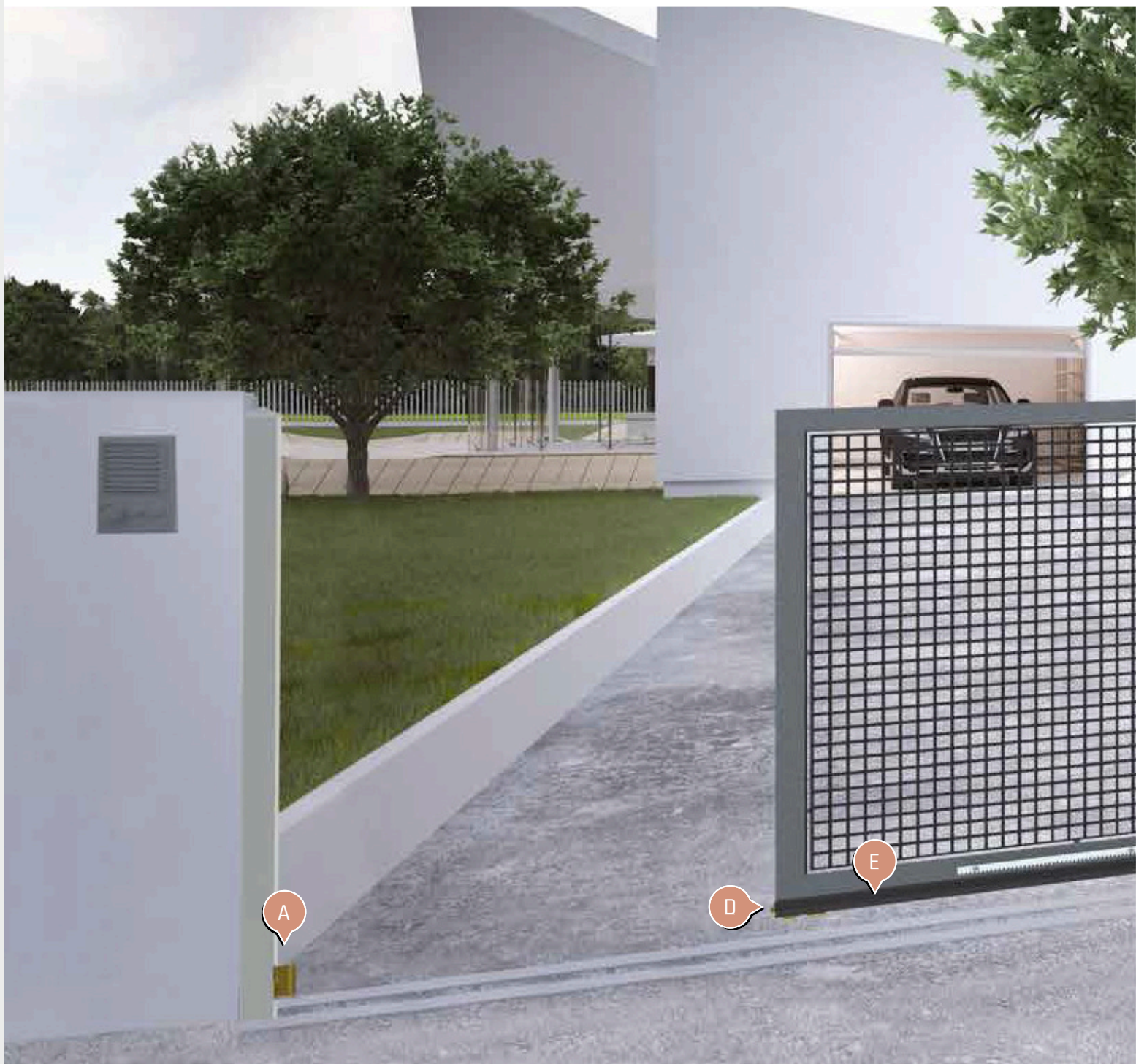

## KIT

2x 50L

1x 2RL

2x CA4 RLS

2x 41BL

2x



50 L

A



B

C

D

E

1x



2 RL

2x



CA4 RLS

2x



41 BL



ART. NON IN KIT

GIPI 4 RP/Z  
GIPI 4 RLG/Z

sp. 3,5  
sp. 3

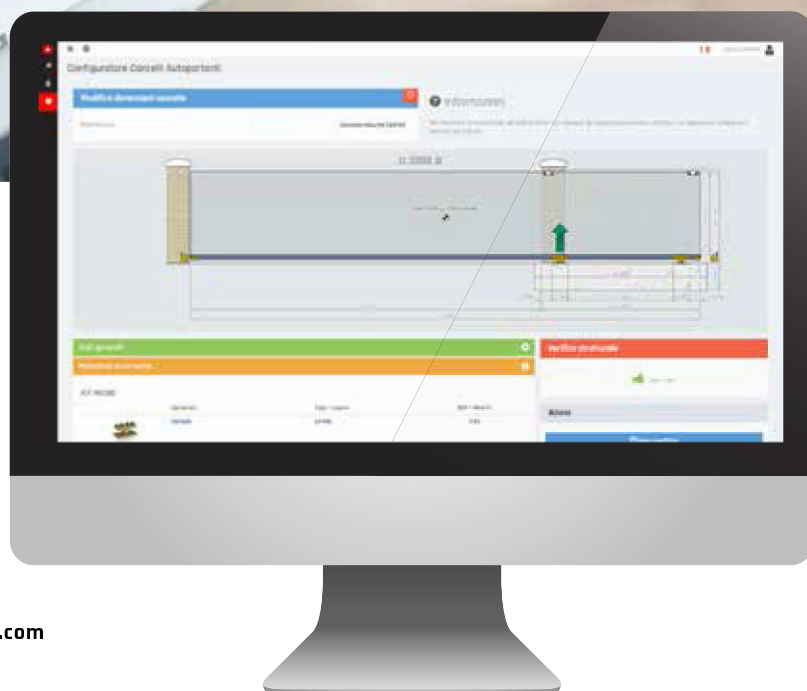
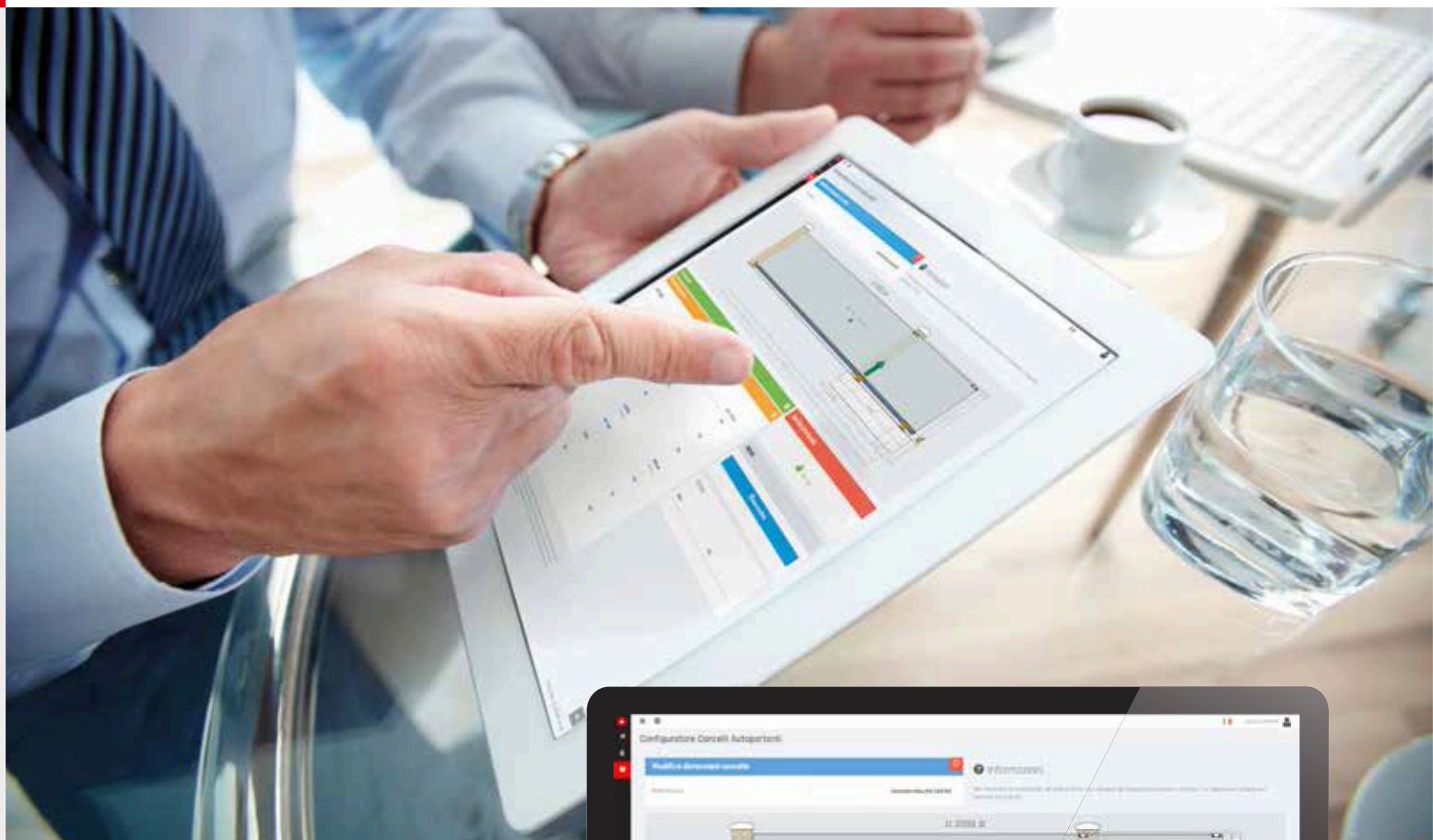

## Online il nuovo configuratore per cancelli autoportati

Compila il modulo di registrazione su [www.rollingcenter.com](http://www.rollingcenter.com)  
Accedi e configura il tuo cancello nei minimi dettagli.

UK

The new cantilever gate configurator is online.  
Enter your data in the registration form on [www.rollingcenter.com](http://www.rollingcenter.com)  
Log in and configure your gate in details.

F

Le nouveau configurateur pour portails porte-à-faux est en ligne.  
Enregistrez-vous sous [www.rollingcenter.com](http://www.rollingcenter.com)  
Connectez-vous et configurez votre portail dans les moindres détails.

RUS

Новый конфигуратор консольных ворот находится в сети.  
Введите свои данные в регистрационную форму на [www.rollingcenter.com](http://www.rollingcenter.com)  
Войдите и настройте ваши ворота в деталях.

D

Der neue Konfigurator für freitragende Schiebetore ist online.  
Füllen Sie das Formular unter [www.rollingcenter.com](http://www.rollingcenter.com) aus.  
Loggen Sie sich ein und konfigurieren Sie Ihr Tor bis ins kleinste Detail.

E

l nuevo configurador para puertas correderas autoportantes está en línea.  
Complete el formulario en [www.rollingcenter.com](http://www.rollingcenter.com)  
Inicie sesión y configure su puerta en detalle.



Articolo - Article		L1	Peso max cancello Gate max weight	Abbinabile Combining		
Riferimento - Reference		Max ML			N°	
KIT CA 4 RLS	KAPLE GTO	3,5	180	GIPI 4 RL / RLZ	1	10,4
KIT CA 4 RLS	KAPLE GTO	4	250	GIPI 4 RP / RPZ	1	10,4

- I Kit carrello "Leggero"
- UK "Light" carriage kit
- D "Leichte" Rollapparate
- F Kit chariot "Léger"
- E Kit carro "Ligero"
- RUS Комплект кареток легкий

Peso max cancello Gate max weight	L1 (m)	L2 (m)	L4 (m)	L5 (m)	LT (m)	H (m)	E (m)	A (m)	B (m)	C (m)	Portata max carrello Carriage strength	Fondazione Armatura	
180	2	0,82	1,5	0,15	3,5	1,7	0,19	1,5	0,6	0,5	360	4 Ø 12	4 Ø 12
180	2,5	0,82	1,5	0,15	4,0	1,7	0,19	1,5	0,6	0,5	360	4 Ø 12	4 Ø 12
180	3	0,82	1,5	0,15	4,5	1,7	0,19	1,5	0,6	0,5	360	4 Ø 12	4 Ø 12
180	3,5	0,82	1,5	0,15	5,0	1,7	0,19	1,5	0,6	0,5	360	4 Ø 12	4 Ø 12
180	4	1,32	2	0,15	6,0	1,7	0,19	1,8	0,6	0,5	360	4 Ø 12	4 Ø 12

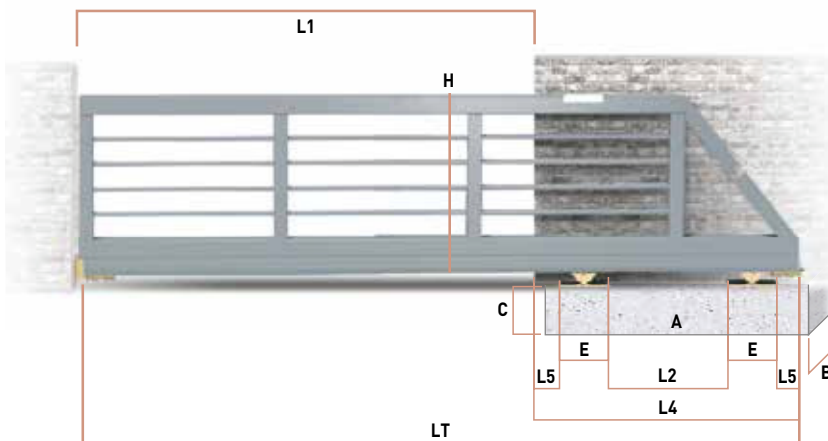
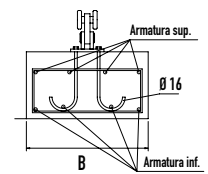

$LT = L1 + L4$

$L2 = 30\% \text{ di } L1$

$L4 = L2 + (E + L5) \times 2$

### Accessori Abbinabili / Combining accessories

CA 4 RLS	x2	41 BL	x2
50 L	x2	GIPI4RP/RL	*
2RL	x1	Gloeck	x1

\* Lunghezza guida variabile  
Variable track length





- I Carrello "Basic" per cancelli autoportanti
- UK "Basic" carriage for cantilever gates
- D "Basic" Rollenapparat für freitragende Schiebetore
- F Chariot "Basic" pour portails autoportants
- E Carro "Basic" para puertas autoportantes
- RUS Тележка для консольных сдвижных ворот базовая

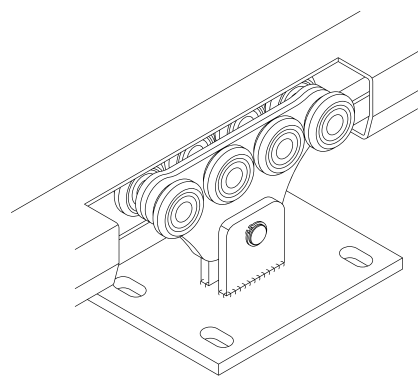

Articolo - Article	L1	Peso max cancello Gate max weight	Abbinabile Combining	
Riferimento - Reference	Max ML			N'
CA 4 RPS	LT 00 50 80	3 - 6	450 kg	GIPI 4 RP / RPZ
				2
				9,58

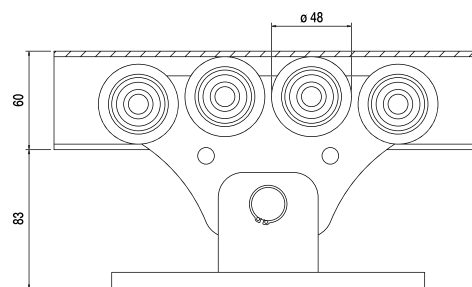
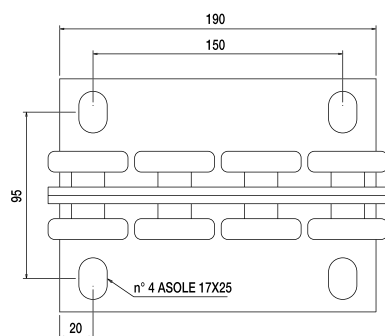
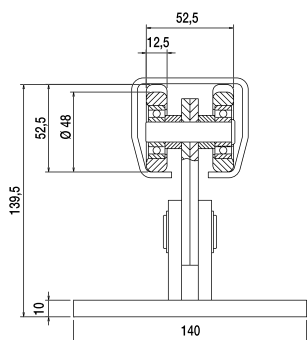

Peso max cancello Gate max weight	L1 (mt)	L2 (mt)	L4 (mt)	L5 (mt)	LT (mt)	H (mt)	E (mt)	A (mt)	B (mt)	C (mt)	Portata max carrello Carriage strength	Fondazione Armatura
450 kg	3,0	0,9	1,66	0,20	4,7	1,7	0,19	1,8	0,6	0,5	900 kg	4 Ø 12 4 Ø 12
450 kg	4,0	1,2	1,96	0,20	6,0	1,7	0,19	2	0,6	0,5	900 kg	4 Ø 12 4 Ø 12
450 kg	5,0	1,5	2,26	0,20	7,3	1,7	0,19	2,3	0,8	0,5	900 kg	4 Ø 12 4 Ø 12
450 kg	6,0	1,8	2,56	0,20	8,6	1,7	0,19	2,6	0,8	0,5	900 kg	4 Ø 12 4 Ø 12

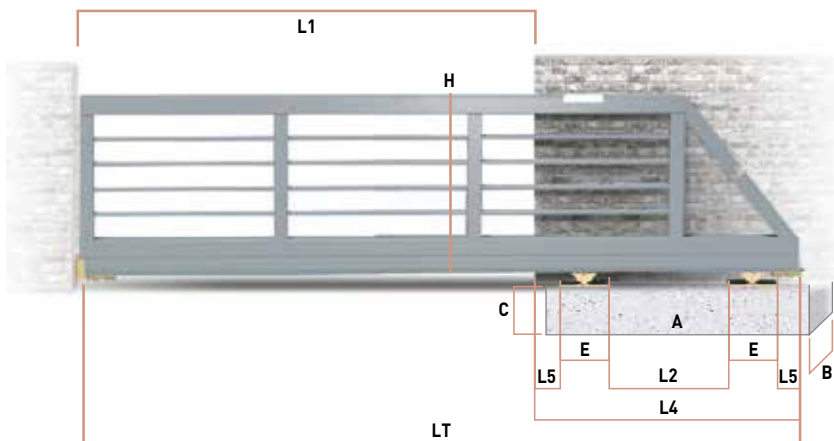
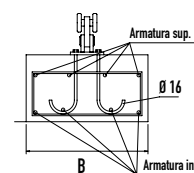

### Accessori Abbinabili / Combining accessories

CA 4 RPS	x2	41 B	x2
50 B	x2	GIPI4RP/Z	*
* Lunghezza guida variabile Variable track length			
2RP P - 4RP P	x2	Gloeck	x1

$$LT = L1 + L4$$

$$L2 = 30\% \text{ di } L1$$

$$L4 = L2 + (E + L5) \times 2$$



- I Carrello "Medio" per cancelli autoportanti
- UK "Medio" carriage for cantilever gates
- D "Medio" Rollenapparat für freitragende Schiebetore
- F Chariot "Medio" pour portails autoportants
- E Carro "Medio" para puertas autoportantes
- RUS Средняя тележка для раздвижных ворот

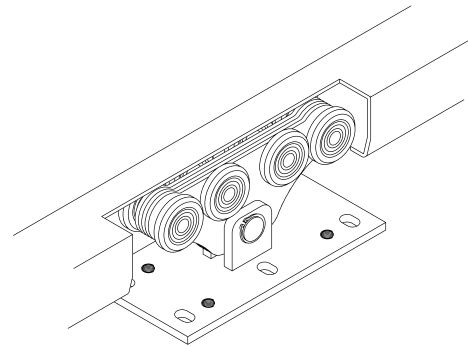

Articolo - Article		L1	Peso max cancello Gate max weight	Abbinabile Combining	
Riferimento - Reference		Max ML			N'
CA 4 RS	LT 00 80 80	8	600	GIPI 5 RG / GZ	2 21

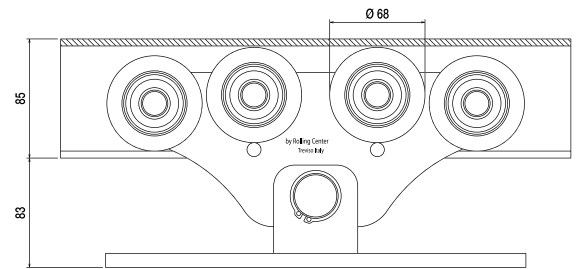
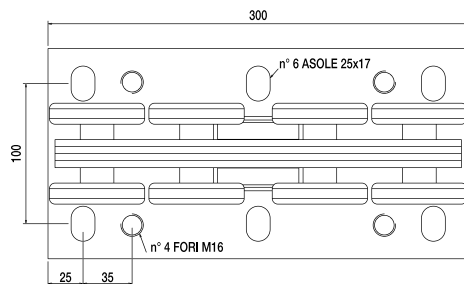
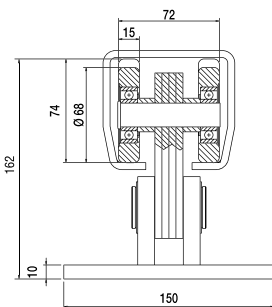

Peso max cancello Gate max weight	L1 (mt)	L2 (mt)	L4 (mt)	L5 (mt)	LT (mt)	H (mt)	E (mt)	A (mt)	B (mt)	C (mt)	Portata max carrello Carriage strength	Fondazione Armatura	
600	4,0	1,20	2,2	0,2	6,2	1,7	0,3	2,5	0,6	0,5	1200	4 Ø 12	4 Ø 12
600	5,0	1,50	2,5	0,2	7,5	1,7	0,3	2,8	0,6	0,5	1200	4 Ø 12	4 Ø 12
600	6,0	1,80	2,8	0,2	8,8	1,7	0,3	3,2	0,6	0,5	1200	4 Ø 12	4 Ø 12
600	7,0	2,10	3,1	0,2	10,1	1,7	0,3	3,7	0,6	0,5	1200	7 Ø 12	4 Ø 12
600	8,0	2,40	3,4	0,2	11,4	1,7	0,3	3,7	0,6	0,5	1200	7 Ø 12	4 Ø 12

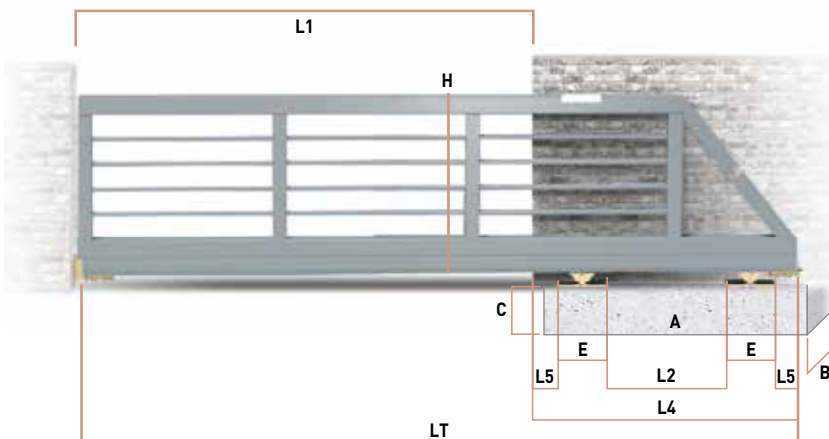
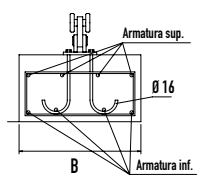

LT = L1+L4      L2 = 30% di L1      L4 = L2+(E+L5) x2

### Accessori Abbinabili / Combining accessories

CA 4 RS	x2	41 P	x2
50 P	x2	GIPI 5 RG/Z	*
* Lunghezza guida variabile Variable track length			
4RM P	x2	Gloeck	x1

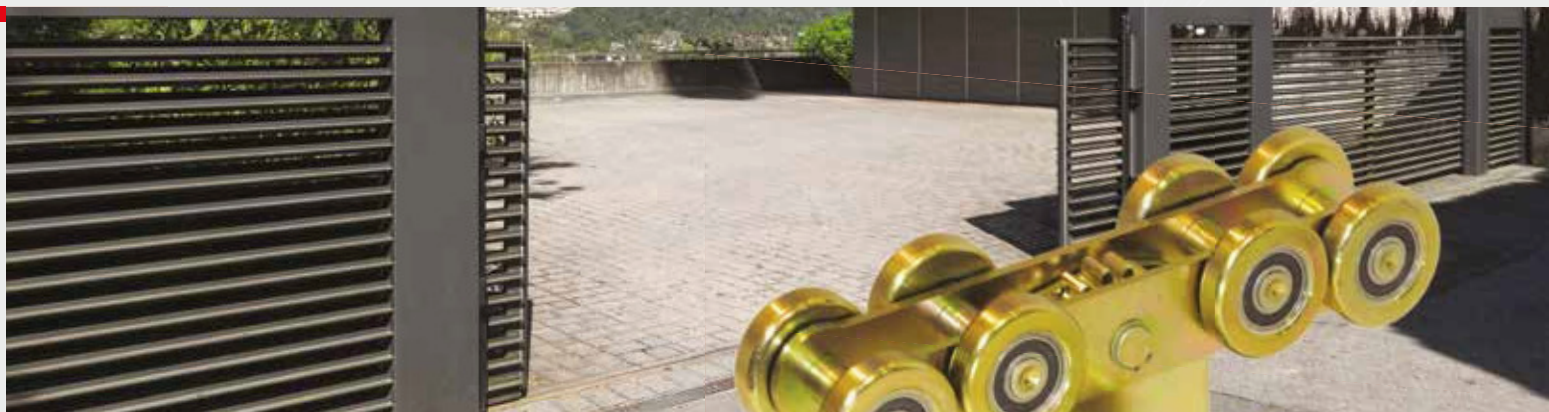

## KITMOTOG NEW

Kit carrello "MotoG" con sistema di aggancio adattabile ai diversi modelli di motore presenti sul mercato.

- ✓ Adatto a cancelli fino a 600kg di peso e 8 metri di apertura
- ✓ Kit composto da 2 carrelli: trainante + condotto
- ✓ Guida GIPI5RG/GZ con cremagliera 44, 22x22 mod. 4
- ✓ Per cancelli autoportanti predisposto per cremagliera interna



"MotoG" trolley kit with connection system adaptable to the different automation models available on the market.

- ✓ Suitable for gates up to 600kg in weight and 8 meters in width
- ✓ Kit consisting of 2 trolleys: pulling + driven
- ✓ Track GIPI5RG/GZ with rack 44, 22x22 mod. 4
- ✓ For cantilever gates with internal dental rack

"MotoG" Trolley-Kit mit Haken-System anpassbar an die verschiedenen auf dem Markt vorhandenen Antriebe.

- ✓ Geeignet für bis zu 600 kg Torgewicht und 8 Meter Toröffnung.
- ✓ Kit bestehend aus 2 Wagen: ein Antriebendes und ein Geführtes
- ✓ Unterholm GIPI5RG/GZ mit Zahnstange 44, 22x22 mod. 4
- ✓ Für freitragende Tore mit interner Zahnstange

Kit trolley "MotoG" avec système d'accrochage adaptable aux différents modèles de automatisme disponibles sur le marché.

- ✓ Convenable pour des portails jusqu'à 600 kg de poids et 8 mètres de largeur
- ✓ Kit composé par 2 chariots: conduite + entraînement
- ✓ Rail GIPI5RG/GZ avec crémaillère 44, 22x22 mod. 4
- ✓ Pour portails porte-à-faux prédisposés pour crémaillère interne

Kit de carros "MotoG" con sistema de enganche adaptable a los diferentes modelos de motores en el mercado.

- ✓ Adecuado para puertas de hasta 600 kg de peso y 8 metros de pasaje
- ✓ Kit compuesto de 2 carros: arrastrante + remolcado
- ✓ Guía GIPI5RG/GZ con cremallera 44, 22x22 mod. 4
- ✓ Para puertas autoportantes predisposadas para cremalleras ocultas

Комплект суппорта "MotoG" с системой зацепления, адаптируемой к различным моделям двигателей, имеющихся на рынке.

- ✓ Пригоден к воротам весом до 600 кг и 8 метрам открытия
- ✓ Комплект состоит из 2 суппортов: ведущего + ведомого
- ✓ Направляющая GIPI5R/GZ с зубчатой рейкой 44, 22x22 мод.4
- ✓ Для самонесущих ворот подготовлены для внутренней зубчатой рейки



## KITMOTOG accessori



- ▶ Z12 M4: RT0412PS
- ▶ Z15 M4: RT0415PS
- ▶ Z16 M4: RT0416PS
- ▶ Z17 M4: RT0417PS
- ▶ Z18 M4: RT0418PS
- ▶ Z20 M4: RT0420PS

Sistema per aggancio motore disponibile in 6 soluzioni di fissaggio.

Automation coupling system available with 6 fixing solutions.

Motor-Kupplungssystem in 6 verschiedenen Befestigungslösungen erhältlich.

Système d'accouplement au moteur disponible en 6 solutions de fixation.

Sistema de acoplamiento al motor disponible en 6 soluciones de fijación.

Система сцепления с двигателем доступна в 6 крепежных решениях.



Aggancio diretto al motore con linguetta tipo DIN6885A 8x7x18

Direct connection to the automation with key DIN6885A 8x7x18

Direkte Verbindung zum Motor mit Passfedern DIN6885A 8x7x18

Connexion directe au moteur avec clavette DIN6885A 8x7x18

Conexión directa al motor con claveta DIN6885A 8x7x18

Прямое подключение к двигателю при помощи шпонки типа DIN6885A 8x7x18



DIMA2 per facilitare la foratura della guida ed il fissaggio della cremagliera interna, tramite viti M6.

DIMA2 to facilitate the drilling of the track and the fixing of the internal dental rack by using M6 screws.

DIMA2 um das Bohren des Unterholms und die Befestigung der inneren Zahnstange mit M6-Schrauben zu erleichtern.

DIMA2 pour faciliter le perçage du rail et la fixation de la crémaillère interne à l'aide de vis M6.

DIMA2 para facilitar el taladrado del perfil y la fijación de la cremallera oculta utilizando tornillos M6.

DIMA2 для облегчения сверления направляющей и фиксации внутренней зубчатой рейки с помощью винтов M6



- I** Kit carrello "MotoG" per cancelli autoportanti predisposto per cremagliera interna
- UK** "MotoG" trolley kit for cantilever gates with internal dental rack
- D** "MotoG" Trolley-Kit prädisponiert für freitragende Tore mit interner Zahnstange
- F** Kit de chariots "MotoG" pour portails porte-à-faux prédisposés pour crémaillère interne
- E** Kit de carros "MotoG" para puertas autoportantes predisposto para cremalleras ocultas
- RUS** Комплект суппорта "MotoG" для самонесущих ворот, подготовленный для внутренней зубчатой рейки.

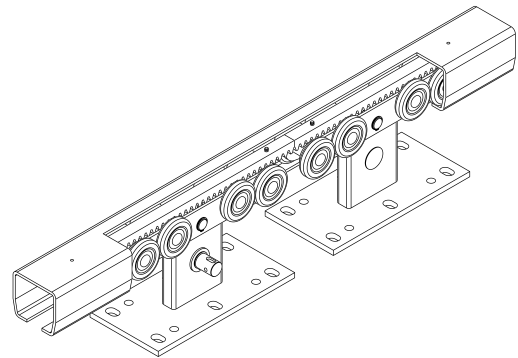

Articolo - Article	L1	Peso max cancello Gate max weight	Abbinabile Combining		
Riferimento - Reference	Max ML			N°	
KIT MOTO G	KA PM OT GT	600	GIPI5RG/GZ + 44	1	19,5

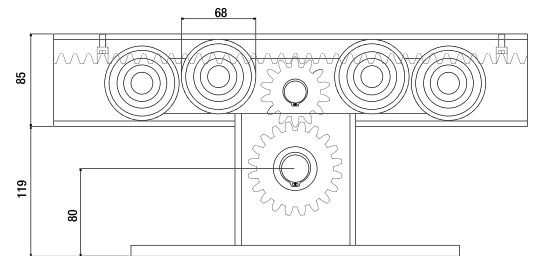
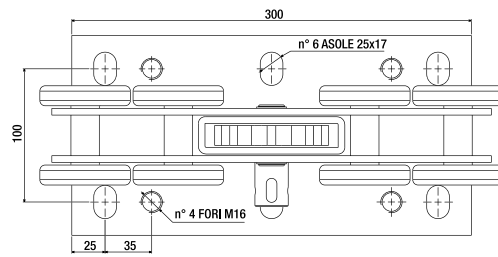
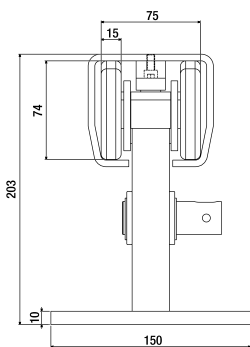

Peso max cancello Gate max weight	L1 (mt)	L2 (mt)	L4 (mt)	L5 (mt)	LT (mt)	H (mt)	E (mt)	A (mt)	B (mt)	C (mt)	Portata max carrello Carriage strength	Fondazione Armatura	
600	4,0	1,20	2,2	0,2	6,2	1,7	0,3	2,5	0,6	0,5	1200	4 Ø 12	4 Ø 12
600	5,0	1,50	2,5	0,2	7,5	1,7	0,3	2,8	0,6	0,5	1200	4 Ø 12	4 Ø 12
600	6,0	1,80	2,8	0,2	8,8	1,7	0,3	3,2	0,6	0,5	1200	4 Ø 12	4 Ø 12
600	7,0	2,10	3,1	0,2	10,1	1,7	0,3	3,7	0,6	0,5	1200	7 Ø 12	4 Ø 12
600	8,0	2,40	3,4	0,2	11,4	1,7	0,3	3,7	0,6	0,5	1200	7 Ø 12	4 Ø 12

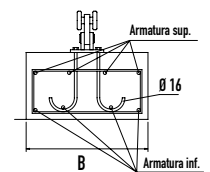

### Accessori Abbinabili / Combining accessories

x1 LT M0 80 80	x1 LT C0 80 80	x1 Z ...	* 44
50 P	x2 GIPI 5 RG/Z	* 41 P	x2
4RM P	x2 Gloeck	x1 DIMA 2	x1

\* Lunghezza guida variabile  
Variable track length

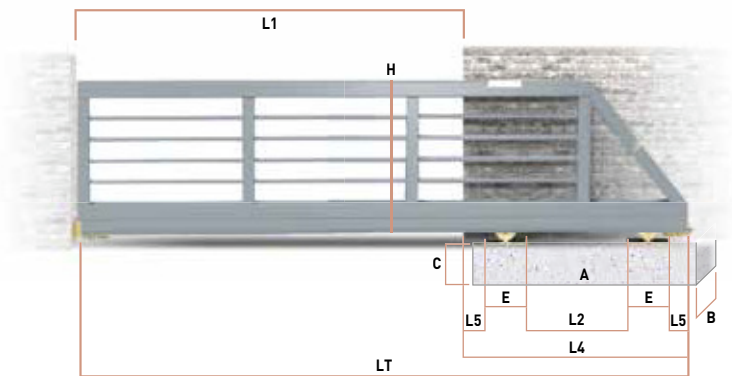

$$LT = L1 + L4$$

$$L2 = 30\% \text{ di } L1$$

$$L4 = L2 + (E + L5) \times 2$$



- I Carrello "H900" per cancelli autoportanti
- UK "H900" carriage for cantilever gates
- D "H900" Rollenapparat für freitragende Schiebetore
- F Chariot "H900" pour portails autoportants
- E Carro "H900" para puertas autoportantes
- RUS Тележка «H900» для раздвижных ворот со щетками

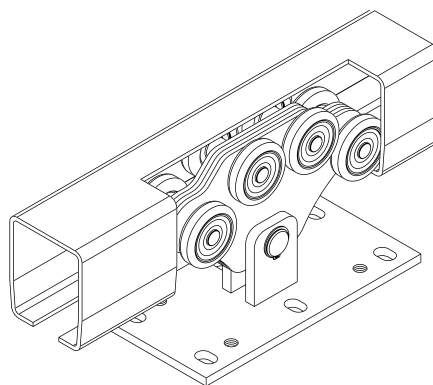

Articolo - Article	L1	Peso max cancello Gate max weight	Abbinabile Combining	
Riferimento - Reference	Max ML			N'
H 900	LT 03 70 80	10	900	GIPI 4 RH / HZ
				2
				26

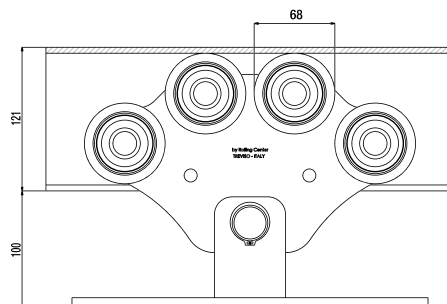
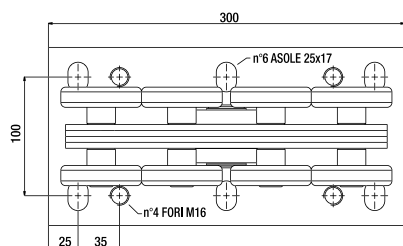
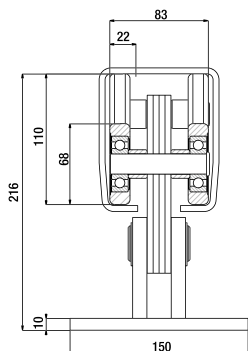

Peso max cancello Gate max weight	L1 (mt)	L2 (mt)	L4 (mt)	L5 (mt)	LT (mt)	H (mt)	E (mt)	A (mt)	B (mt)	C (mt)	Portata max carrello Carriage strength	Fondazione Armatura
900	6,0	1,80	2,8	0,2	8,8	1,7	0,3	3,1	0,6	0,5	1800	4 Ø 12 4 Ø 12
900	7,0	2,10	3,1	0,2	10,1	1,7	0,3	3,4	0,6	0,5	1800	4 Ø 12 4 Ø 12
900	8,0	2,40	3,4	0,2	11,4	1,7	0,3	3,7	0,6	0,5	1800	4 Ø 12 4 Ø 12
900	9,0	2,70	3,7	0,2	12,7	1,7	0,3	4,0	0,6	0,5	1800	7 Ø 12 4 Ø 12
900	10,0	3,00	4,0	0,2	14,0	1,7	0,3	4,3	0,6	0,5	1800	7 Ø 12 4 Ø 12

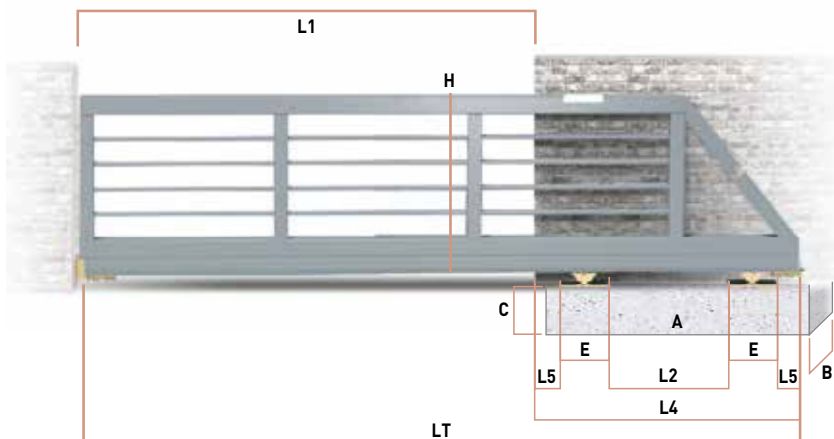
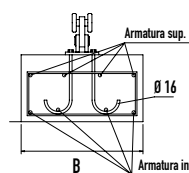

LT = L1+L4

L2 = 30% di L1

L4 = L2+(E+L5) x2

Accessori Abbinabili / Combining accessories

H 900	x2	41 H SPEC	x2
50 H	x2	41 H	153/H
4RM P	x2	GIPI4RH/Z	*
		* Lunghezza guida variabile Variable track length	
		Gloeck	x1



- I Carrello "Magnum" per cancelli autoportanti
- UK "Magnum" carriage for cantilever gates
- D "Magnum" Rollenapparat für freitragende Schiebetore
- F Chariot "Magnum" pour portails autoportants
- E Carro "Magnum" para puertas autoportantes
- RUS Тележка «Магнум» для раздвижных ворот

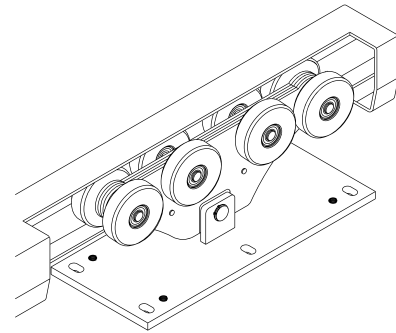

Articolo - Article		L1	Peso max cancello Gate max weight	Abbinabile Combining	
Riferimento - Reference		Max ML			N'
CA 4 RMS	LT 01 20 80	16	1200	GIPI 6 RM / MZ	1 44,6

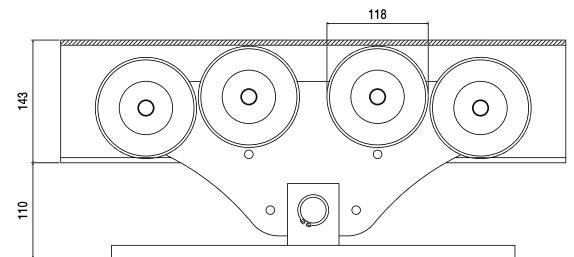
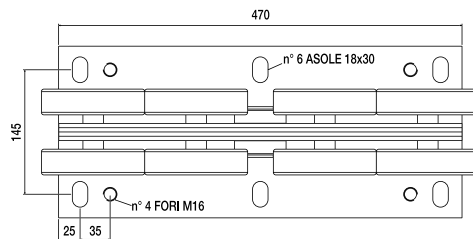
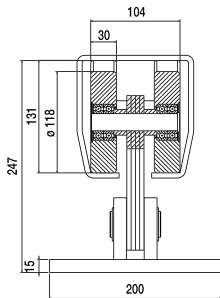

Peso max cancello Gate max weight	L1 (mt)	L2 (mt)	L4 (mt)	L5 (mt)	LT (mt)	H (mt)	E (mt)	A (mt)	B (mt)	C (mt)	Portata max carrello Carriage strength	Fondazione Armatura
1200	9,0	2,7	4,04	0,2	13,0	1,7	0,47	4,2	0,6	0,5	2400	6 Ø 12 4 Ø 12
1200	10,0	3,0	4,34	0,2	14,3	1,7	0,47	4,2	0,6	0,5	2400	6 Ø 12 4 Ø 12
1200	11,0	3,3	4,64	0,2	15,6	1,7	0,47	4,8	0,8	0,6	2400	7 Ø 12 4 Ø 12
1200	12,0	3,6	4,94	0,2	16,9	1,7	0,47	4,8	0,8	0,6	2400	7 Ø 12 4 Ø 12
1200	13,0	3,9	5,24	0,2	18,2	1,7	0,47	5,4	0,8	0,6	2400	9 Ø 12 4 Ø 12
1200	14,0	4,2	5,54	0,2	19,5	1,7	0,47	5,4	0,8	0,6	2400	9 Ø 12 4 Ø 12
1200	15,0	4,5	5,84	0,2	20,8	1,7	0,47	6	0,8	0,6	2400	10 Ø 12 4 Ø 12
1200	16,0	4,8	6,14	0,2	22,1	1,7	0,47	6,2	0,8	0,6	2400	10 Ø 12 4 Ø 12

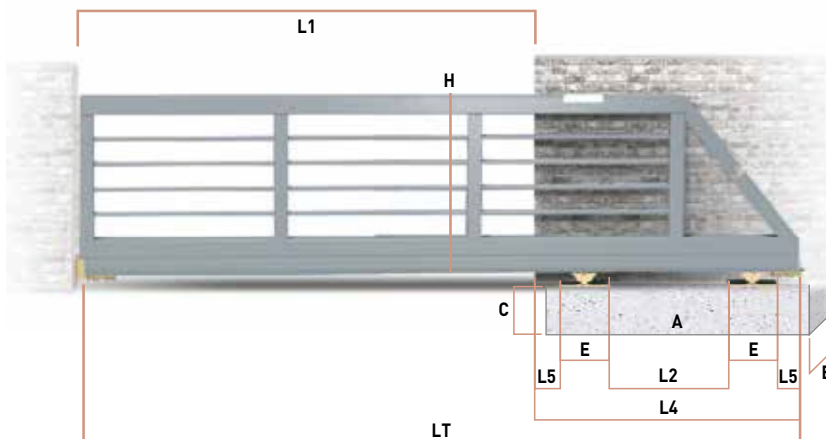
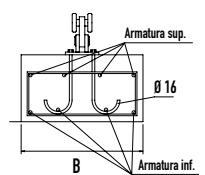

$LT = L1 + L4$

$L2 = 30\% \text{ di } L1$

$L4 = L2 + (E + L5) \times 2$

### Accessori Abbinabili / Combining accessories

CA 4 RMS

x2



41 G

x2



50 G

x2



85 G

x2



GIPI6RM/MZ

\*



\* Lunghezza guida variabile  
Variable track length

2RGZ / 4RG P

x2



Gloeck

x1





- I Carrello "Magnum2" per cancelli autoportanti
- UK "Magnum2" carriage for cantilever gates
- D "Magnum2" Rollenapparat für freitragende Schiebetore
- F Chariot "Magnum2" pour portails autoportants
- E Carro "Magnum2" para puertas autoportantes
- RUS Тележка «Магнум2» для раздвижных ворот

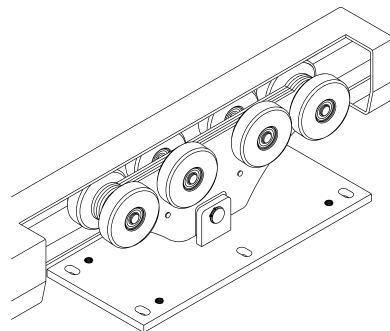

Articolo - Article	L1	Peso max cancello Gate max weight	Abbinabile Combining	
Riferimento - Reference	Max ML			N'
CA 4 RMS2	LT 01 20 82	18	2200	GIPI 4 RM2 / M2C
				1 45,2

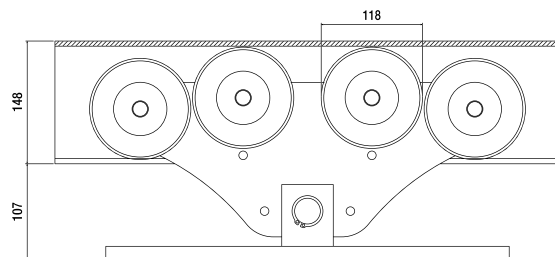
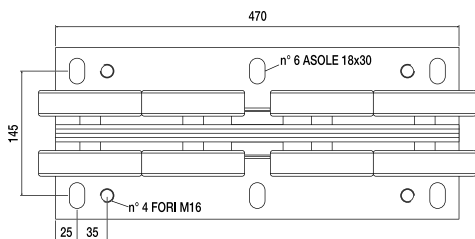
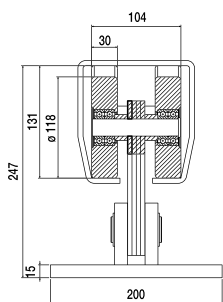

Peso max cancello Gate max weight	L1 (mt)	L2 (mt)	L4 (mt)	L5 (mt)	LT (mt)	H (mt)	E (mt)	A (mt)	B (mt)	C (mt)	Portata max carrello Carriage strength	Fondazione Armatura	
2200	9,0	2,7	4,04	0,2	13,0	1,7	0,47	4,2	0,5	0,5	4400	6 Ø 12	4 Ø 12
2200	10,0	3,0	4,34	0,2	14,3	1,7	0,47	4,2	0,5	0,5	4400	6 Ø 12	4 Ø 12
2200	11,0	3,3	4,64	0,2	15,6	1,7	0,47	4,8	0,8	0,6	4400	7 Ø 12	4 Ø 12
2200	12,0	3,6	4,94	0,2	16,9	1,7	0,47	4,8	0,8	0,6	4400	7 Ø 12	4 Ø 12
2200	13,0	3,9	5,24	0,2	18,2	1,7	0,47	5,4	0,8	0,6	4400	9 Ø 12	4 Ø 12
2200	14,0	4,2	5,54	0,2	19,5	1,7	0,47	5,6	1	0,8	4400	9 Ø 12	4 Ø 12
2200	15,0	4,5	5,84	0,2	20,8	1,7	0,47	6	1	0,8	4400	10 Ø 12	4 Ø 12
2200	16,0	4,8	6,14	0,2	22,1	1,7	0,47	6,2	1	0,8	4400	10 Ø 12	4 Ø 12
2200	17,0	5,1	6,44	0,2	23,4	1,7	0,47	6,5	1	0,8	4400	10 Ø 12	4 Ø 12
2200	18,0	5,4	6,74	0,2	24,7	1,7	0,47	7	1	0,8	4400	10 Ø 12	4 Ø 12

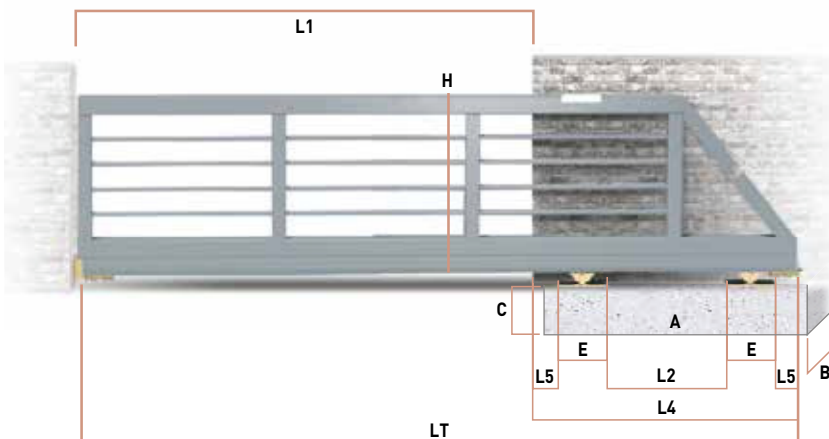
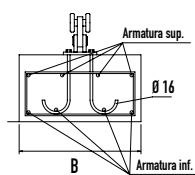

$LT = L1 + L4$

$L2 = 30\% \text{ di } L1$

$L4 = L2 + (E + L5) \times 2$

### Accessori Abbinabili / Combining accessories

CA 4 RMS2	41 G
50 G	85 G
	GIPI4RM2/M2C
	* Lunghezza guida variabile Variable track length
2RGZ / 4RG P	Gloeck

SUPERMAGNUM 2



SUPERMAGNUM 3



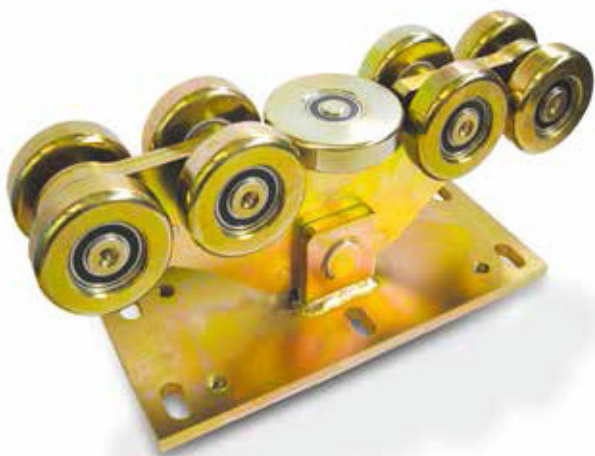

**I** Carrello SUPERMAGNUM2 con ruota di guida per cancelli autoportanti molto pesanti

**UK** "SUPERMAGNUM2" carriage with guiding wheel for heavy duty cantilever gates

**D** "SUPERMAGNUM2" Rollenapparat mit zentraler Führungsrolle für schwere freitragende Schiebetore

**F** Chariot "SUPERMAGNUM2" avec roue de guidage pour portails autoportants très lourds

**E** Carro "SUPERMAGNUM2" con puleggia di guida para puertas autoportantes muy pesadas

**RUS** Тележка «SUPERMAGNUM2» с направляющим роликом для очень тяжёлых раздвижных ворот

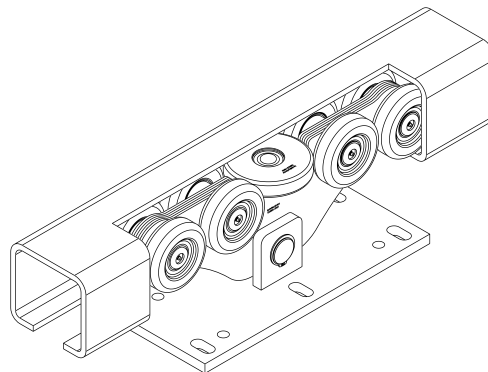

Articolo - Article	L1	Peso max cancello Gate max weight	Abbinabile Combining	
Riferimento - Reference	Max ML			N'
CA 4 RSMS2 LT 01 35 81	30	4500	GIPI 4 RSM	1 77

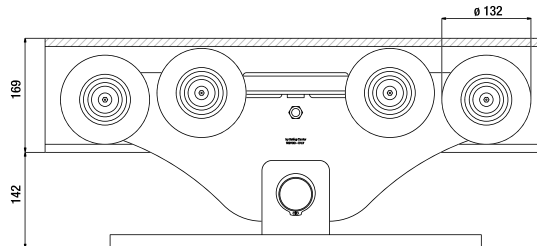
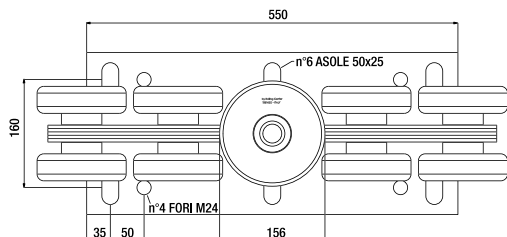
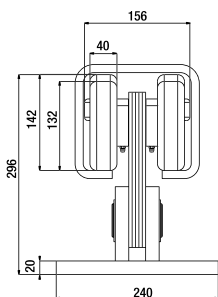

Peso max cancello Gate max weight	L1 (mt)	L2 (mt)	L4 (mt)	L5 (mt)	LT (mt)	H (mt)	E (mt)	A (mt)	B (mt)	C (mt)	Portata max carrello Carriage strength
4000	15	6	7,9	0,4	22,9	1,7	0,55	<b>ATTENZIONE*</b> La struttura del cancello, date le dimensioni e pesi elevati, deve essere calcolata e verificata da uno studio tecnico ingegneristico, per garantirne la tenuta statica.			7000
4000	20	8	9,9	0,4	29,9	1,7	0,55				7000
4000	25	10	11,9	0,4	36,9	1,7	0,55				7000
4500	30	13,5	15,4	0,4	45,4	1,7	0,55				7000

**Fondazione Armatura**

**ATTENZIONE\***  
La struttura del cancello, date le dimensioni e pesi elevati, deve essere calcolata e verificata da uno studio tecnico ingegneristico, per garantirne la tenuta statica.

\*CAUTION The structure of the gate, by the size and heavy weight, must be calculated and verified by a technical engineering study to avoid any static failure.

**Accessori Abbinabili / Combining accessories**

CA 4 RSMS2  x2	41 SM  x2
50 SM  x2	GIPI 4 RSM  *
Gloeck  x2	

\* Lunghezza guida variabile  
Variable track length

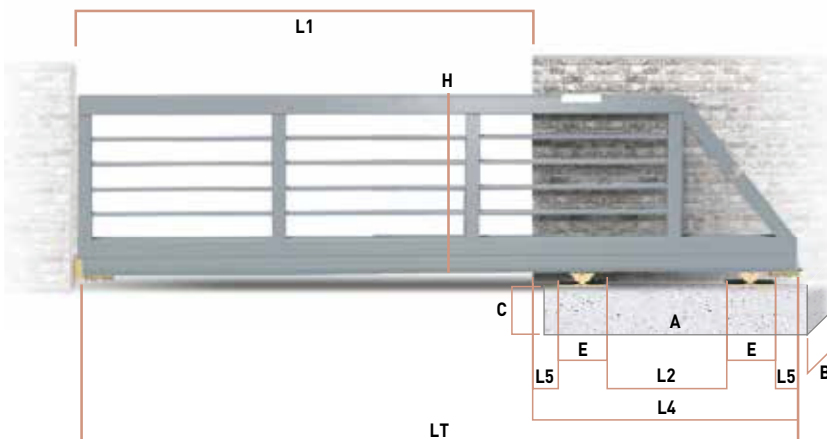

$LT = L1 + L4$

$L2 = 40\% \text{ di } L1$

$L4 = L2 + (E + L5) \times 2$

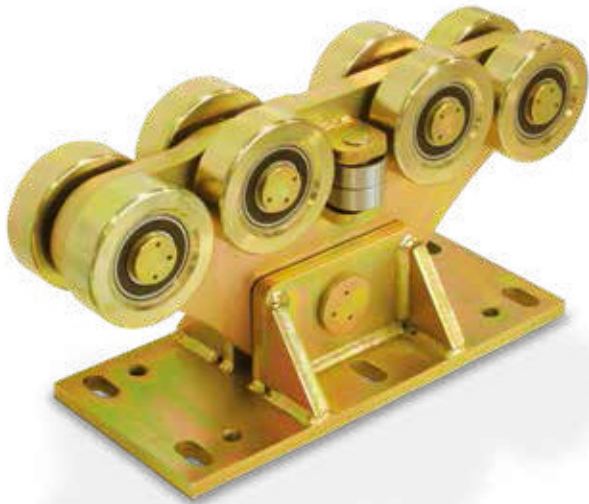

- I** Carrello SUPERMAGNUM3 con cuscinetti di guida per cancelli autoportanti molto pesanti
- UK** SUPERMAGNUM3 trolley with lateral guide bearings for very heavy cantilever gates
- D** SUPERMAGNUM3 Rollenbock mit seitlichen Führungskugellagern für sehr schwere freitragende Tore
- F** Chariot SUPERMAGNUM3 avec roulements de guidage pour portails porte-à-faux très lourds
- E** Carro SUPERMAGNUM3 con rodamientos laterales de guía para puertas autoportantes muy pesadas
- RUS** Тележка SUPERMAGNUM3 с направляющими подшипниками для очень тяжелых раздвижных ворот

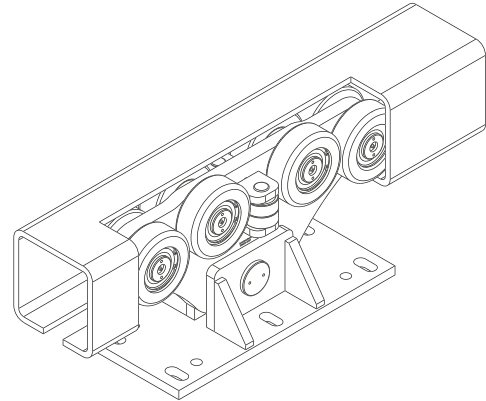

Articolo - Article	L1	Peso max cancello Gate max weight	Abbinabile Combining	
Riferimento - Reference	Max ML			N°
SM3	LT 01 50 81	30	7000	GIPI 12 SM3
				1 112

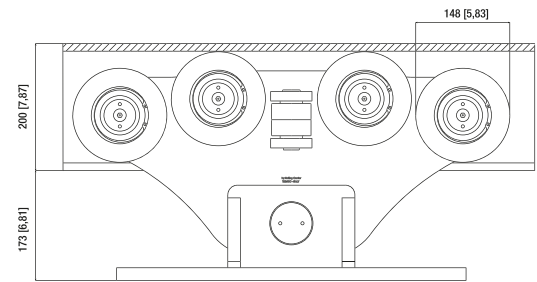
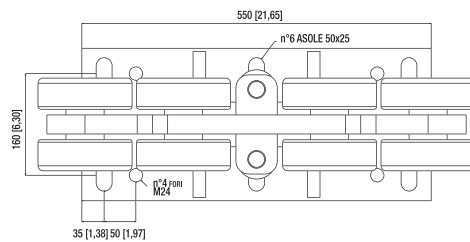
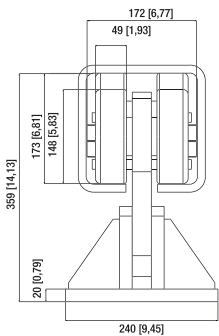

Peso max cancello Gate max weight	L1 (mt)	L2 (mt)	L4 (mt)	L5 (mt)	LT (mt)	E (mt)	A (mt)	B (mt)	C (mt)	Portata max carrello Carriage strength
7000	8	3,2	5,3	0,52	13,3	0,55	<b>ATTENZIONE*</b> La struttura del cancello, date le dimensioni e pesi elevati, deve essere calcolata e verificata da uno studio tecnico ingegneristico, per garantire la tenuta statica.			17000
7000	12	4,8	6,9	0,52	18,9	0,55		17000		
7000	16	6,4	8,5	0,52	24,5	0,55		17000		
7000	20	8	10,1	0,52	30,1	0,55		17000		

**Fondazione Armatura**

**ATTENZIONE\***  
La struttura del cancello, date le dimensioni e pesi elevati, deve essere calcolata e verificata da uno studio tecnico ingegneristico, per garantire la tenuta statica.

\*CAUTION The structure of the gate, by the size and heavy weight, must be calculated and verified by a technical engineering study to avoid any static failure.

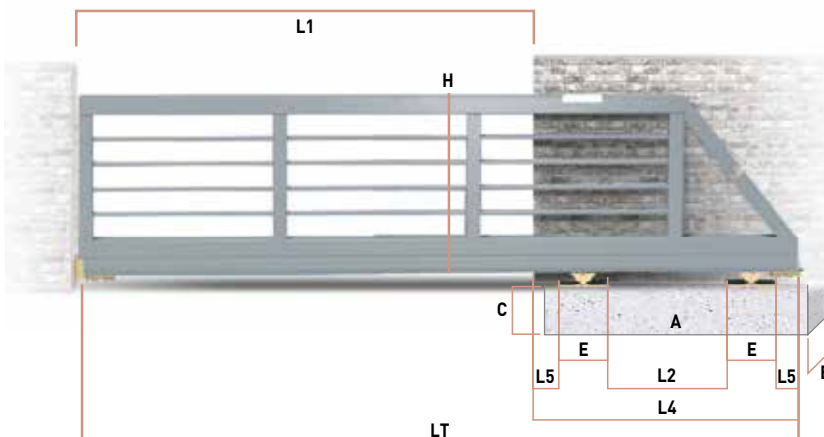

### Accessori Abbinabili / Combining accessories

SM3	x2	41 SM3/SPEC	x2
Gloeck	x2	GIPI 12 SM3	*

\* Lunghezza guida variabile  
Variable track length

LT = L1+L4

L2 = 40% di L1

L4 = L2+(E+L5) x2

# Guide in acciaio per carrelli autoportanti

## Steel tracks for cantilever carriages

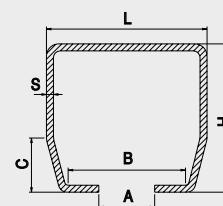

Articolo - Article			Abbinabile Combinig	L	H	A	B	C	S	Finitura	Barra	Fasce Sheafs	
Riferimento - Reference				mm							ML	ML	
	GIPI 4 RLZ 51	BZ 69 59 00	CA4RL SILENT L	69	59	55	52,5	25	3	Zincato	5,1	91,8	438
	GIPI 4 RL 51	BG 69 59 00		69	59	22	52,5	25	3	Grezzo	5,1	91,8	438
	GIPI 4 RPZ 3	BZ 70 60 03	CA4RL CA4RP SILENT L SILENT P	70	60	22	53	25	3,5	Zincato	3	96	545
	GIPI 4 RP 3	BG 70 60 03		70	60	22	53	25	3,5	Grezzo	3	96	545
	GIPI 4 RPZ 6	BZ 70 60 00		70	60	22	53	25	3,5	Zincato	6	192	1092
	GIPI 4 RP 6	BG 70 60 00		70	60	22	53	25	3,5	Grezzo	6	192	1092
	GIPI 5 RG 3	BG 94 85 03	CA4RS KIT MOTO G SILENT G	94	85	33	73	30	5	Grezzo	3	60	714
	GIPI 5 RGZ 3	BZ 95 85 03		94	85	33	73	30	5	Zincato	3	60	714
	GIPI 5 RG 6	BG 94 85 06		94	85	33	73	30	5	Grezzo	6	60	1428
	GIPI 5 RGZ 6	BZ 95 85 06		94	85	33	73	30	5	Zincato	6	60	1428
	GIPI 4 RH 3	BG 12 10 03	H 900 H 900 S	101	121	36	86	41	5	Grezzo	3	30	431
	GIPI 4 RHZ 3	BZ 12 10 03		101	121	36	86	41	5	Zincato	3	30	431
	GIPI 4 RH 6	BG 12 10 06		101	121	36	86	41	5	Grezzo	6	30	862
	GIPI 4 RHZ 6	BZ 12 10 06		101	121	36	86	41	5	Zincato	6	30	862
	GIPI 6 RM 3	BG 14 14 03	CA 4 RMS SILENT M	136	143	38	104	55	6	Grezzo	3	45	1020
	GIPI 6 RMZ 3	BZ 14 14 03		136	143	38	104	55	6	Zincato	3	45	1020
	GIPI 6 RM 6	BG 14 14 06		136	143	38	104	55	6	Grezzo	6	45	2034
	GIPI 6 RMZ 6	BZ 14 14 06		136	143	38	104	55	6	Zincato	6	45	2034
	GIPI 4 RM 2/3	BG 14 15 03	CA 4 RMS2	140	148	38	106	57	8	Grezzo	3	27	810
	GIPI 4 RM2C 3	BZ 14 15 C3		140	148	38	106	57	8	Zincato a caldo	3	27	810
	GIPI 4 RM 2/6	BG 14 15 06		140	148	38	106	57	8	Grezzo	6	27	1620
	GIPI 4 RM2C 6	BZ 14 15 C6		140	148	38	106	57	8	Zincato a caldo	6	27	1620
	GIPI 4 RSM	BG 17 18 00	CA 4 RSMS2	184	169	74	160	-	12	Grezzo	4,5	4,5	240
	GIPI 12 SM3	BG 20 20 06	SM3	200	200	50	-	-	12,5	Grezzo	6	6	408